

A-A

SPECIFICATIONS:

1. Voltage: 125V AC RMS
2. Current Rating: 1.5A
3. Contact Resistance: 40mΩ MAX.
4. Insulation Resistance: 500MΩ MIN.
5. Dielectric Withstand Voltage : 500V DC
6. Operature Temperature: -40°C~80°C
7. Durability: 750 Mating Cycles MIN.

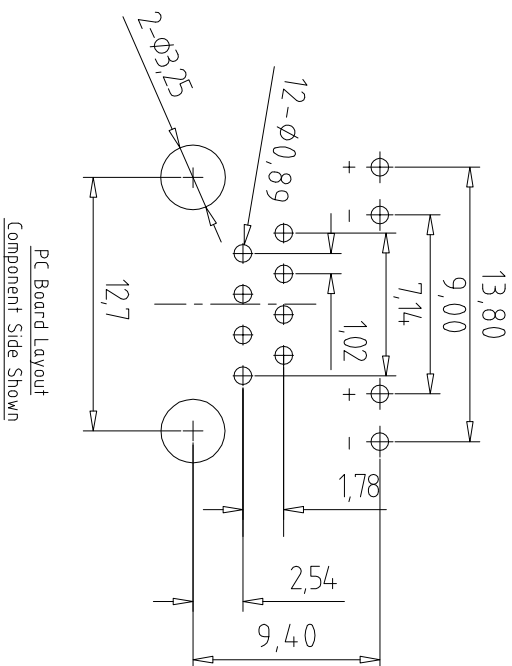
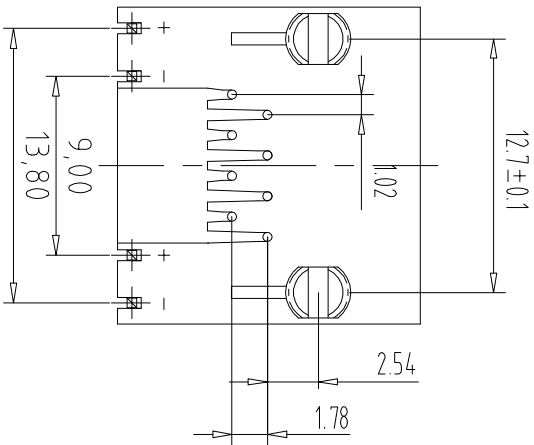

5	LED	1	LED Lamp2(Right)	GREEN	
4	LED	1	LED Lamp1(Left)	YELLOW	
3	Shielding	1	Brass	Ni Plating	
2	Terminal	8	Phosphor Bronze	PLATING & COLOR	
1	Housing	1	PBT	BLACK	

APPROVALS		DATE	
DRAWN	ZHWJGJEN	2015.07.07	

GEPU 歌普

CHECKED		TITLE: RJ CONNECTOR	
APPROVALS		PART NO.	RJ45-6W11-DVGC-BB-88-B1
TOLERANCES ARE		UNIT: mm	SCALE: 1:1
30°	±0.30	ANGLE	PROJ
5°	±0.05	DRAWING NO.	SHEET 1 OF 1

ECN NO.	REV.	DATE.	DESCRIPTION.	CHANGE.	CHECK.	APPRO.
	A		NEW			